

# Single Relay Module

The Single Channel Relay, is a heavy duty, mechanically latched, DIN rail mounted relay and is rated at 20 Amps continuous use. The relay can withstand high in-rush currents and is suitable for incandescent, high intensity discharge lamps and fluorescent loads.

The relay module features a set of auxiliary contacts (normally open) and mechanical on/off control for manual operation.

The single channel relay must be used in conjunction with the 5504RDP series of relay driver products.

## TECHNICAL INFORMATION

Catalogue Number	<b>5000RL20</b>
Line Supply Voltage	<b>220-240VAC</b>
Supply Frequency	<b>47-53Hz and 57-63Hz</b>
Load Rating per Channel	<b>20A AC3</b>
Contact Type	<b>Voltage free, normally open, mechanically latched</b>
Switch Operations	<b>Greater than 30,000 operations</b>
Auxiliary Contacts	<b>Normally open</b>
In-Rush Current	<b>300A (80msec)</b>
Compatible Loads	<b>Resistive, inductive, incandescent and fluorescent</b>
Load Termination	<b>2 x 1.5mm<sup>2</sup> or 1 x 2.5mm<sup>2</sup></b>
Dimensions	<b>1.5M (M = 17.5mm)</b>
Operating Temperature Range	<b>0 °C to 45 °C</b>
Operating Humidity Range	<b>0 - 95% RH, non-condensing</b>
Compliances	<b>RCM, CE</b>



5000RL20

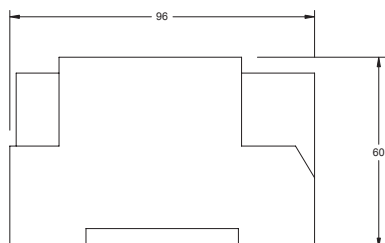
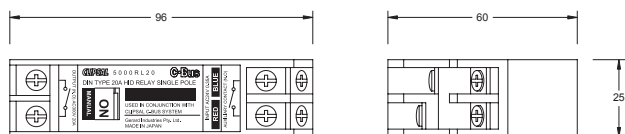

CATALOGUE NUMBER	DESCRIPTION
5000RL20	Single Relay, 20A (High In-Rush Current)